

**DOCUMENTING A FAMILY:
THE GREEN-DEROUSSE-LEWIS
FAMILY IN CHAMPAIGN
COUNTY, 1858-1900**

COMPILED BY MICHELE MCNABB

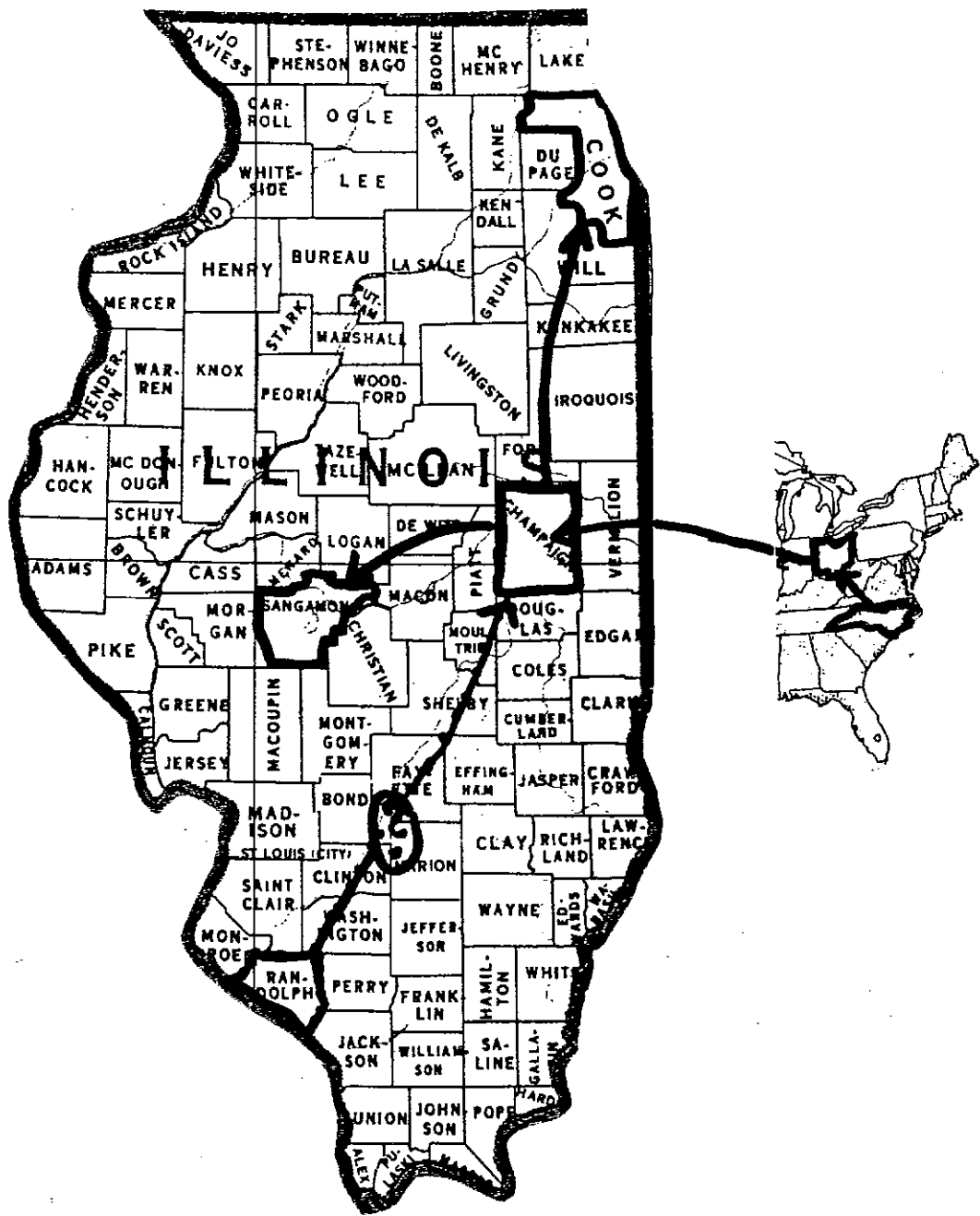

This project started with the discovery of an obituary for a man named E. A. Green in an 1870 Champaign newspaper. In those days only a few deaths were reported in the newspaper; those that did get printed were usually only brief statements giving limited information about the date and circumstances of the individual's death. But this obituary was different. Besides the bare facts, additional information was given about the deceased so that one could see that he was a respected man who enjoyed a good reputation among his peers. What made this obituary exceptional is the fact that Mr. Green was a man of color. Prior to the 1880s very few blacks lived in Champaign Urbana. This obituary is almost certainly the first printed for a black resident of the community.

I became curious about E. A. Green. Who was this seemingly exceptional man? I decided to try to discover something about him and his family. What was discovered is shown in the form of a timeline of events. Each event is illustrated by a document, accompanied by some comments and conclusions. At the end I show what is known about this family using family group sheets.

All the research was done using materials found in the Champaign County Historical Archives. Similar documentation will exist for other individuals and families and in them other stories that are waiting to be discovered and told.

DIED.

GREEN—In this city, on the morning of the 28th ult., of consumption, Mr. E. A. Green, aged 53 years.

The deceased was one of the first colored men who settled in this city, having located here in 1857. He was a man of much more than ordinary intelligence and information, few being better posted upon the political and historical events of this country: He was a good neighbor, a skillful and industrious mechanic, and an honest man. His works were for good among his own people, whom he taught many practical lessons, ever urging them to acquire knowledge and so deport themselves as to become good citizens.

1. From this obituary, published in the "Champaign County Gazette" of May 4, 1870, we learn a few facts about Mr. Green: that he died on April 27 of consumption at the age of 53, and that he first came to the County in 1857. This provides some clues for looking for him in other sources.

2. The earliest records found for E.A. Green indicate that he purchased several parcels of land in West Urbana (as Champaign was then named) and Urbana beginning in 1858. From these records we find out that his first name was Edward and that he must have come to Champaign County with some financial resources.

GRANTEE INDEX, CHAMPAIGN COUNTY, ILL.

(Refer to index in front portion of book for alphabetical arrangement and page reference to all the index.)

FAMILY NAME	GRANTOR			1. No. of Inst.	2. DATE OF FILING		3. AMOUNT	4. BOOK AND PAGE	5. DESCRIPTION OF PROPERTY
	A B C D E F G H	I J K L M N O	P Q R S T U X V W Y Z		1900	1901			
Essex			John P. White	112	22	16	771	111-110	72-19-8
do			John Clark	"	3	24	771	111-110	11-1-17
do			W. D. Coffeen	"	4	6	771	111-112	Comptrol + 2 1/2 feet wide add
do			John P. White	"	12	28	771	111-115	777 7/8 + 111 7/8
do			William John Comptrol	"	3	1	771	111-115	1/2 lot 1/2 in 3 Comptrol + 1/2 in 1/2
do			David Green	"	5	5	771	111-128	1/2 lot
Green			Low State of Illinois	111	3	22	771	111-128	do
do			Justice W. Young	111	4	22	771	111-128	Sub No 128 SW 7-19-9
do			Benj F. Johnson	"	4	3	771	111-128	1/2 SW 1/4 Sec 18 9 EA. White add
do			Francis J. Mulholland	"	4	1	771	111-128	1/2 SW 1/4 Sec 18 9 EA. White, 1/2 in 1/2
do			John P. White	"	4	1	771	111-128	do
do			James Green	"	4	1	771	111-128	do
do			James Green	"	4	1	771	111-128	do
do			John P. White	"	4	1	771	111-128	do

2. Grantee Index to Deeds, "Green"

3. The 1860 census had no listing for an Edward Green; however, a carpenter named Edwin Green was listed as head of a household in the city of Champaign. Besides his occupation, we also learn here that Green was born in North Carolina around 1820. Also living in the household are three females, Anna (age 12) and Florence (age 10), both born in Ohio, and Julia (age 19), who, like Green, was also born in North Carolina. These 4 individuals are listed as being 'mulatto,' i.e., of mixed blood. Also living in the household is 24-year-old laborer John Benton, born in North Carolina. It is unclear whether he too is a person of color.

Relationships were not given in the 1860 census, but we can make some tentative guesses: Edwin Green apparently moved at some time from his home state to Ohio, where he probably married an unknown woman some time before 1848 (the year Anna was born). Since Florence was also born in Ohio, the family should be listed in the 1850 census of that state. Julia is too young to be the girls' mother; possibly she is Edward's younger sister. No other record of her has been found.

1850 CENSUS — UNITED STATES

State Ohio County Brown ^{Town}~~Township~~ Union Call No. M32-662

Page	Dwelling Number	Family Number	Name	Age	Sex	Color	Occupation, etc.	Value-Real Estate	Birthplace	Married within year	School within year	Cannot read or write	Enumeration Date	Remarks
32A	473	477	Edward Green	28	M	M	Carpenter	280	NC				10 Aug	
			Georgeanna "	30	F	M			Ky					
			Ann "	2	F	M			OH					
			Florence "	5/12	F	M			OH					
			William Depew	8	M	M			OH					
			Charlotte Bruce	18	F	B			NC					
	472	476	R. J. Green	23	M	M	Carpenter	-	NC			✓		
			Mrs. S. Green	21	F	M			SC					
			Ferne Fole	2	M	M			NC					
			Margaret Augusta	40	F	B			Ky			✓		
	474	478	Elijah Osbon	64	M	(w)	Carpenter	1000	MD					

Dwell- ing No.	Name in full	Age	Sex	Color	years of age.	Value owned
1	2	3	4	5	6	7
	William T. Hughes	6	Mo	B		
	Esther do	3	F	B		
	John H. do	10	Mo	B		
	Andrew Jackson	31	Mo	B	Labourer	
472	476 H. J. Green	93	Mo	W	Carpenter	
	Mrs. S. Green	21	F	W		
	Hornie Cole	2	Mo	W		
	Margaret Augusta	19	F	B		
473	477 Edward Green	28	Mo	W	Carpenter	250
	Georgeanna do	30	F	W		
	Emily do	2	F	W		
	Horace do	5	F	W		
	William DeRen	8	Mo	W		
	Charlotte Price	18	F	B		
474	478 Elizabeth Osborn	64	Mo		Carpenter	1000
	Mrs. Osborn	39	F			
	do					

10	11	12	13	14	15	16	17	18	19	20	21	22	23	24	25	26	27	28	29	30	31	32	33	34	35	36	37	38	39	40	41	42	43	44	45	46	47	48	49	50	51	52	53	54	55	56	57	58	59	60	61	62	63	64	65	66	67	68	69	70	71	72	73	74	75	76	77	78	79	80	81	82	83	84	85	86	87	88	89	90	91	92	93	94	95	96	97	98	99	100					
5	6	7	8	9	10	11	12	13	14	15	16	17	18	19	20	21	22	23	24	25	26	27	28	29	30	31	32	33	34	35	36	37	38	39	40	41	42	43	44	45	46	47	48	49	50	51	52	53	54	55	56	57	58	59	60	61	62	63	64	65	66	67	68	69	70	71	72	73	74	75	76	77	78	79	80	81	82	83	84	85	86	87	88	89	90	91	92	93	94	95	96	97	98	99	100
Color.	years of age.	Value of DWDE	or Country.	Married	year.	Aspects	with	Persons of	who can	Money	supplies	Country	State																																																																																		
No. 10			Kentucky																																																																																												
No. 11			No.																																																																																												
No. 12			No.																																																																																												
No. 13			Germany																																																																																												
No. 14			North Carolina																																																																																												
No. 15			South No.																																																																																												
No. 16			North No.																																																																																												
No. 17			Kentucky																																																																																												
No. 18		250	North Carolina																																																																																												
No. 19			Kentucky																																																																																												
No. 20			Ohio																																																																																												
No. 21			No.																																																																																												
No. 22			No.																																																																																												
No. 23			North Carolina																																																																																												
No. 24		1000	Maryland																																																																																												
No. 25			Pennsylvania																																																																																												

1
2
3
4
5
6
7
8
9
10
11
12
13
14
15
16

SCHEDULE — Free Inhabitants in City of Champaign in the County of Champaign State of Illinois enumerated by me, on the 25th day of Sept 1860. E. J. McCall Asst Marshal
 Post Office Champaign

Dwelling-houses— numbered in the order of visitation.	Families numbered in the order of visitation.	The name of every person whose usual place of abode on the first day of June, 1860, was in this family.	DESCRIPTION.			Profession, Occupation, or Trade of each person, male and female, over 15 years of age.	VALUE OF ESTATE OWNED.		Place of Birth, Naming the State, Territory, or Country.	Married within the year.	Attended School within the year.	Persons over 20 years of age who cannot read & write.	Whether deaf and dumb, blind, insane, idiotic, pauper, or convict.
			Age.	Sex	Color, White, black, or mulatto		Value of Real Estate.	Value of Personal Estate.					
1	2	3	4	5	6	7	8	9	10	11	12	13	14
2531	2460	Edwin Green	48	m	W	Confession	1200	200	North Carolina				
		Armin "	12	f	"				Ohio		X		
		Florence "	10	"	"				"		X		
		Julia "	14	"	"	Domestic			North Carolina				
		Robin Benton	24	m	W	Labourer			"				
2532	2461	William Heyde	48	"	W	Farmer	1000	100	New York				
		Eleanor "	34	f	W				Ohio				
		Sophia "	7	"	W				Illinois				
		George Heyde	14	m	W				Ohio				

4. In the 1860s Edward A. Green continued to buy and sell land. Some of these (starred entries in the grantee index) were located in what is known as the Seminary addition to Urbana, and will figure later in this story. From one of these deeds we can see that Green paid cash for the land. The map shows where some of these parcels of land were located.

GRANTEE INDEX CHAMPAIGN COUNTY, ILL

Refer to sub-index in front portion of book for (a) cancelled assignments and (b) page references to original deeds.

FAMILY NAME	GRANTEE			1. Book 2. Page	DATE OF DEED		AMOUNT	PAGE	DESCRIPTION OF PROPERTY	
	Given Names ABCDEFCH	Given Names IJKLMNO	Given Names PQRSTUVWXYZ		Month	Year				
Bacon	Augustus		John Smith	10	10	57				
Do	Augustus		John Smith	11	29	54				
Do	Edward A		John E. Bafocce et al	12	12	65	300	339	Seminary add to Urbana	
Do	Edward A		Henry Bacon	12	26	64	400	341		32 20
Do		John E	S. C. R. Company	11	22	64				
Do		William J. Davis	Thomas E. Duane et al	1	4	65	1751	255	NE 1/4	7 17
Do		James A. Jacy	Thomas M. Jacy et al	1	20	65	3200	195	SE 1/4	21 19
Do		John M. Jacy	Thomas M. Jacy et al	10	6	65		4		(20 9)
Do		John A	Lambert H. Bantwell et al	10	7	65	1455	200		
Do	Edw A		John Lee et al	9	18	60	200	170		
Do	Edw A		John Lee et al	9	19	60	800	595	Sub mt 1/2 S 1/2	7 12
Do	Edward A		Jonathan C. Stodolter	7	31	60	100	55		
Do		James P.	Joseph Collier et al	5	18	61		8		
Do	D. H.		John H. Lancaster	3	15	67	1500	150	Curto E. Columbus add Champ	
Do			John H. Lancaster	4	3	67	1000	45		17 18
Do			John H. Lancaster	17	7	67		9		
Do	Joseph		John H. Lancaster	8	1	67	300	394	1 acre off N 1/2 S 1/2	30 20
Do			John H. Lancaster	9	19	67		13		
Do			John H. Lancaster	11	13	67		13		
Do			John H. Lancaster	11	30	65		13		

This Indenture, made this twenty eighth day of July in the year of our Lord
 Eighteen Hundred and sixty four between Jonathan C. Stoughton and Amanda C.
 his wife & John C. Babcock and Elvira J. his wife of the County of Kane and State of
 Illinois of the first part and Edward A. Boardley of the County of Champaign and
 State of Illinois of the second part witnesseth: That the said party of the first
 part, for and in the consideration of One Hundred dollars to them paid the
 receipt whereof is hereby acknowledged, do grant, bargain sell, convey and confirm
 unto the said party of the second and to his heirs and assigns a certain tract or
 parcel of land, with the appurtenances lying and being in the County of Champaign
 and State of Illinois, described as follows, to wit: Lot Eight (8) & Nine (9) in Block
 Twelve (12), as per plat of Survey addition to Urbana as recorded in said
County to have and to hold the aforesaid granted premises, to the said party
of the second part his heirs and assigns to him and their heirs and assigns
forever and the said party of the first part do hereby for themselves and their heirs and assigns and
 their heirs and assigns with the said party of the second part his heirs and assigns that
 they and their heirs and assigns do hereby certify, for the aforesaid premises, that they are free of all incum-
 brances that they have good right to sell and convey the same to the said party of the second
 part and that they and their heirs executors and administrators will warrant and defend the
 said tract of land, to the said party of the second part his heirs and assigns, from
 against the lawful claims and demands of all persons. In witness whereof the said party
 of the first part have hereunto set our hands and seals on the day and year first above
 written

U. S. Revenue Stamp
 To amount of 30¢
 on this deed

Jonathan C. Stoughton
 Amanda C. Stoughton
 John C. Babcock
 Elvira J. Babcock







State of Illinois }
 Kane County }

P. Edward A. Boardley Notary Public in and for the town
 of Urbana in said County do hereby certify that the above named Jonathan C. Stoughton
 and Amanda C. Stoughton (who are personally known to me to be the persons whose
 names are subscribed to the foregoing deed as having executed the same) this day in

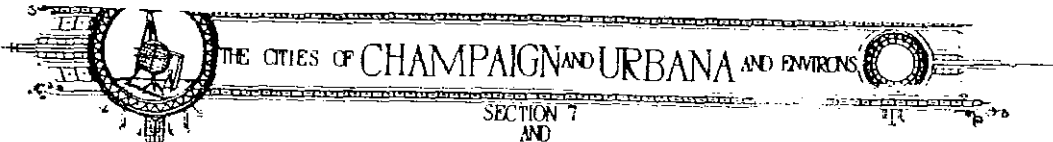
4c. 1929 Plat Map of Champaign-Urbana, showing the location of the lots mentioned in the foregoing deed.



Scale 400 feet to 1 inch

CHAMPAIGN URBANA

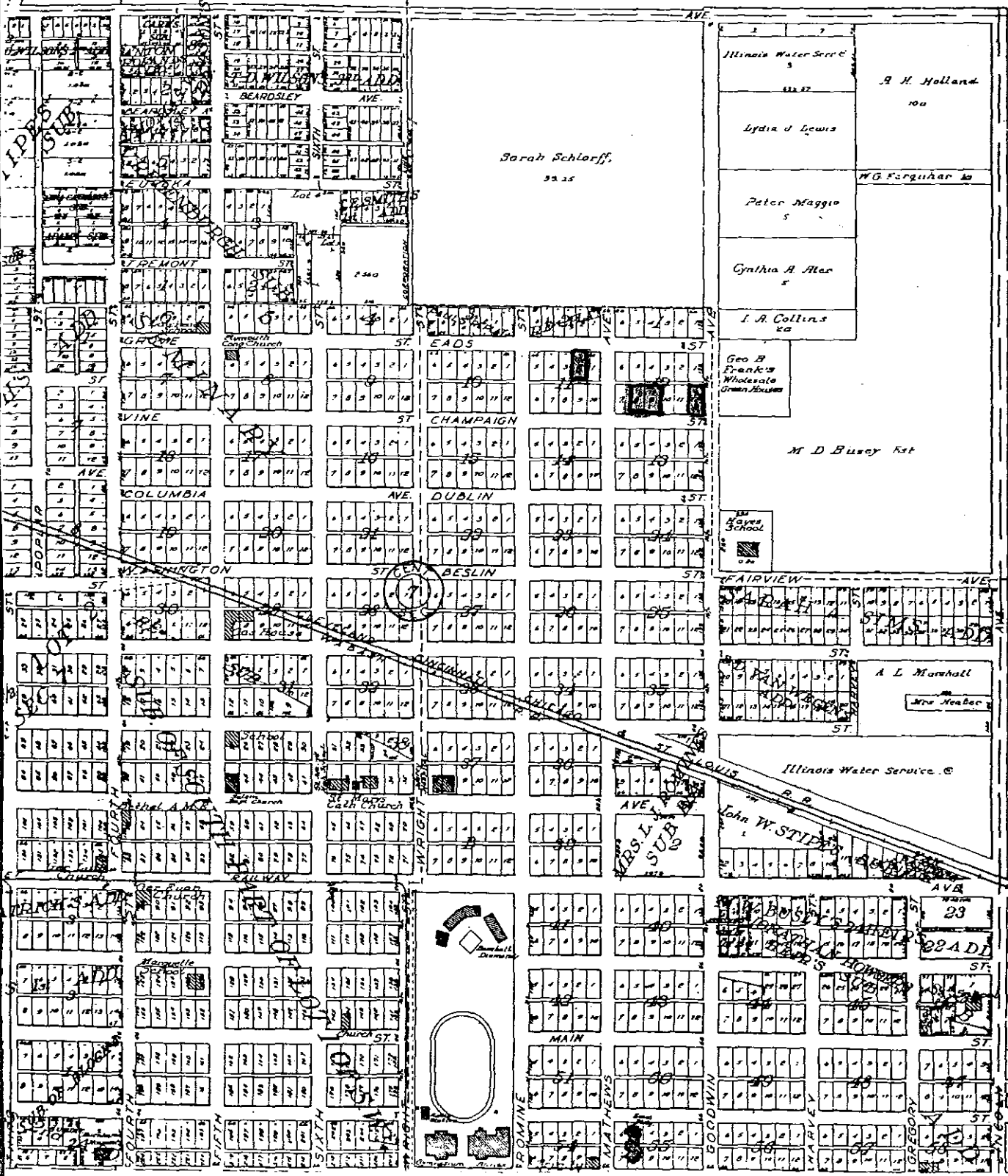

FOR SECTION 8 SEE PAGES 16 AND 17

5. On September 18, 1865, a justice of the peace married Edward A. Green to Miss Eva Derosse, who was living in Champaign at the time.

day, Strideaway and the
 rain trotted for a purse of
 heat was to Dan Mars—
 he second was to Stride-
 36; the 3rd and 4th to
 time 2:36 and 2:37.
 er and Bay Dick were also
 a purse of \$75—\$50 to
 to second; half with heats
 Bay Dick won in two
 —time 3:31 seconds.

State News.
 A hundred pound nugget
 was taken out of the big
 mine south of Warren, a
 co.
 opinion tobacco county of
 is in Williamson. Three
 tipped for 1869.

in Leavenworth, Crawford
 for oil a few days ago,
 of salt water and have
 two excellent salt wells.
 the farmers in Mason
 concluded that their wheat
 fit to pay for harvesting.
 number of farmers of St.
 have bought steam thresh-
 ered in the east, and
 rain by steam.

Successful completion of the
 tie cable was celebrated
 Wednesday, at Liberty
 re gathering was in at
 the Germania. Massac-
 red the audience with
 J. Y. Scammon presided
 the opening address. H.
 Council, spoke in French,
 Frank Davis and others,
 speeches were also deliv-
 n. The celebration was

the necessary improvements of our busi-
 ness streets. What is it?

EMANCIPATION CELEBRATION.

On the 20th of August, 1833, an act
 passed the British Parliament which
 liberated and set free the slaves of the
 West India Islands on the 1st day of
 August, 1834. By this single act of
 legislation the shackles were struck from
 the limbs of 800,000 African slaves.—
 Since then it has been the custom of
 the free colored people in the Northern
 States to celebrate this event in an
 appropriate manner. In accordance
 with this custom of long standing, last
 Monday the colored folks of Champaign,
 Urbana, and vicinity, celebrated the
 35th anniversary of the British Emancipation.
 The appropriateness of
 such a proceeding now, seems lost since
 the liberation of over four millions of
 slaves in America, but the custom has
 been observed since the Emancipation
 Proclamation, not so much in
 remembrance of the humane act of the
 British Government as by way of an
 annual reminder of the fact that the sons
 and daughters of Africa were, but re-
 cently in bonds as slaves. It can read-
 ily be seen that close upon the heels of
 such reminders must come feelings of
 thankfulness for the deliverance and
 feelings of deepest gratitude to the
 party and to the men who were the de-
 liverers.
 The celebration of which we now
 write, transpired last Monday. After
 forming in procession and moving
 through some of the main streets.

See back
 side

ay more th.
 at the bulk
 not in tak
 ery divided
 teachers at

two of or
 lem into or
 introduced in

Several residences in this city. We have a
 period of the following advantages: 1st
 Teachers say that in two years they have
 never heard a single complaint of cold feet—
 the floors are always warm. 2d. The rooms
 are always equally heated in all parts—chi-
 dren in the rear of the room are as comfort-
 able as though they were seated near the stove.
 3d. The air in the room is always much purer
 than that of any other kind of heating. It
 has a fresh, clean, and healthy odor to the
 children. It has taken thirty tons of coal
 and about eight cords of wood to thorough-
 heat the building, including halls, for each
 of the past two years. You can estimate ex-
 pense from this. The only objection we have
 found to the use of the furnace is a disposi-
 tion of the fire-boxes to burn out prematurely
 and thus make the repairs costly.

We are now making some repairs on an old
 brick building, and will probably heat it with
 a ventilating stove manufactured by Benson
 Bros., Cincinnati, Ohio. I find they are ex-
 tensively used in the Cincinnati Schools, and
 give good satisfaction. They certainly are
 great improvement over the old style. They
 cost \$25 each, boxed ready for shipping.

You may see this as you see it. I will
 cheerfully answer any other questions you may
 wish to ask. I would advise you to run over
 and see our buildings before you do anything
 with yours. Yours truly,

E. A. GOSTMAN,
 Clerk and Sup't. District Public Schools,
 I concur to the foregoing.
 W. M. HAMMER,
 President Board of Education, District Public
 Schools.

By reference to the records of the Ur-
 bana Graded School, for the year just closed
 that there was consumed about fifty-nine tons
 of coal and the average daily attendance of the pupils.

M. S. BERRY, Chairman Board of Education
 Since the above has been in type we
 learn that the Board of Education have
 resolved to introduce the Kuttan heater
 and ventilator and probably before our
 paper is published the same will be
 lot.

CHAMPAIGN COURIER

Republican Journal—Devoted to Politics, General and Local News

CHAMPAIGN, ILLINOIS, WEDNESDAY,
August 4, 1869

ews.
set is talked of
ed Haven to the
ory, which into
electing Garfield
248 majority.
ecently received
set from some
era.
leman traveling
etary Boutwell's
y strengthenen-
ernment abroad.
rainged for the
ousand Chinese
e Pacific Rail-
s contracted for
s accepted the
State Central
e campaign in
k on the even-
ugust, at such
ed by the Com-
Chief Engineer

this large crowd of orderly and well
colored people, repaired to a
beautiful grove on the farm of Colter
Stewart. Here a bountiful repast was
spread, and after hearty indulgence,
came a season of amusement. In the
course of the afternoon the crowd was
assembled and listened to appropriate
remarks from Rev. G. W. Riley, Dr.
J. W. Scroggs, Mr. E. A. Green and
Rev. R. V. Reed.

The assembly was large and orderly
and the whole affair passed off in good
order and fine style. No doubt it will
be conducive of good. We hope so,
at least.

STABBING AFFAIR.—J. W. Neville,
of Kankouk and T. W. Roach, of Louis-
ville, were both in attendance at the
late horse fair with fast nags. Thurs-
day morning last, it chanced that both
were exercising and training their
horses on the track, preparatory to the
afternoon performance. While thus

POLICE ITEMS.—The docket of Esq.
Hess shows that the following cases have
been disposed of in the police court.
July 27, Charles Wilcox, drunk, \$3 and costs.
July 28, Edward Zeller, drunk \$3 and costs.
July 29, Pat Conway, drunk and disorderly \$4
and costs.
July 29, Thomas Hamilton, drunk \$3 and costs.
July 29, J. W. Neville, disorderly \$10 and costs.
July 30, J. E. Graham, drunk \$3 and costs.
July 30, John Fair, drunk \$3 and costs.
Aug. 1, Wm. Cup, drunk \$3 and costs.
Aug. 2, Jerome Hawley, drunk \$3 and costs.
Aug. 2, John Fair, drunk \$3 and costs.

READY FOR DELIVERY.—The agent
for Crawford & Co.'s "Illinois Central
Directory" will deliver copies of the
work in a few days to the subscribers
in this vicinity. It embraces a brief
history of the various towns on the
Illinois Central railroad, with a directory
of leading business men in each. It is
as full and complete as such a work
could well be and will be found a valu-
able assistant to all. Mechanically it is
well executed, being printed on good
white paper with clear bold type.

I
To be
pail wher
Angle, S.
W
I
and Ciste
at Angle,
W
My
The yo
My Lov
formed th
ly impro
the well
Shuck &
family re
proved.
and their
Main str
W
The
The g

6. As we have seen, Edward A. Green died in the spring of 1870. The federal census for that year, taken on June 29th, two months after Edward's death, finds the Green household living in Champaign. It now consists of the following individuals:

household #238
family #24

GREEN, Evvy, 22 yrs, female, black, keeping house, b. IL
 , Anna, 21 yrs, female, black, at home, b. OH
 , Florance, 20 yrs, female, mulatto, teaching school, b. OH
 , Leopold, 9 yrs, male, mulatto, at home, b. IL
 , Gertrude, 8 mos, female, mulatto, at home, b. IL

Evvy Green was in possession of \$2000 worth of real estate and \$400 worth of personal property.

This census tells us that Edward Green apparently married a much younger woman. His two daughters, not yet married, remain in the household. One is a schoolteacher. Eva Derousse Green was apparently born around 1848 in Illinois. In the 1850 census index a number of Derousse families are listed in the Randolph County area, bordering the Mississippi River, but so far no links have been made between Eva and these families. -- Edward and Eva have an infant daughter. The relationship of the young male in the household, Leopold Green, is uncertain. He would appear to be Edward's son, but is too old to be Eva's child, and no other marriage for Edward has been found in Champaign County. Possibly he might be the son of Julia Green from the 1860 census.

7. In the 1870-71 Champaign County directory we find Mrs. Eva Green listed as residing on Neil Street, and working as a hairdresser.

- Goodman ———, grain dealer, bds Hill st, 1 d w Neil
Goodwin Rev W R, res s s Park st, 3 d e State
Gordinier Philip, blacksmith, res s s Clark st, 2 d e 3d
Gorman James, laborer, res Walnut st, bet Main and North
Gossett Levi, potter, res e s Locust st, 2 d s Street R R
Gould W, school teacher, res Columbia st, 2 d w Neil
Gould Henry, machinist I C R R, res n e cor 2d South and Lo-
cuse sts
Gras Geo, blacksmith
Gray Napoleon, laborer, bds Clark st, 1 d e First
Graybill Chas, R R engineer, res Lynn st, bet Main and Clark
Graybill John, farmer, res Chestnut st, near south end
Grabbel Chas, I C R R, res bet Springfield av and White st
Graham John, res s w cor Park and First sts
Graham John, saloon keeper, res w s 1st st, 1 d s Park
Graham Robt, fireman I C R R, res Neil st, 1 d s I B & W R R
Granger Geo, engineer I C R R, bds n w cor Church & Third sts
Gray Henry, carpenter, res Maple st, 7 d n Randolph
Grayberry John, res s s Hill st, 1 d w Fourth
Green A W, painter, res s s Church st, 8 d w Lynn
Green Edwin, shoemaker, bds University av, 3 d e 1st st
Green Mrs Eva, hair dresser, res Union Bl'k, Neil st, (up stairs)

Green T B, dealer in hardware (Trevelt & Green), bds Doane
House
GREENE NAT, druggist, bds s e cor Third st and Univer'ty av
Greene L, bookkeeper (with Flynn & Scroggs), bds s e cor
Third st and University av
Greene Mrs M A, res s e cor University av and Third st
Gregory T B, carpenter, w s Seventh st, n I B & W R R
Gregory J M, regent I I University, res w s 4th st, 1 d s St R R
Grein John, carpenter, res n s Hill st, 1 d e Third
Griffith ———, blacksmith, bds n s Hill st, 2 d w Neil
Grishman H, res Church st, 2 d w Third
Griswold E C, mason, res n e cor Springfield av and Fourth st
GROOM ELIZABETH, milliner, res s s Main st, 3 d e Neil
(up stairs)
Groves Louis, cigar maker, bds n w cor 3d st and Univer'y av
Groll A, baker, bds Park st, 1 d e First
Grosbeck Charles, res n e cor Hill and Third sts
Groupe Rev H, res Columbia st, 3 d e Randolph
Guinnip Luther, plasterer, res near n w cor Columbia and Ran-
dolph sts
Gulick G, res cor Randolph and Columbia sts

8. Edward A. Green died without leaving a will, but because he owned substantial property, his estate was probated and an administrator had to be appointed. Eva Green chose Thos. A. Reed to act in this capacity. The initial petition for letters of administration shows the date and place of Green's death, lists his property, and names his heirs: his widow Eva, and daughters Anna A., Florence E., and Gertrude L. Note that Leopold is not mentioned; hence, he was not Edward's son. As part of the probate procedure Green's property had to be itemized and appraised. This document showing the personal property selected by the widow included furniture, carpentry equipment and 'one lot of books.'

Petition of J. A. Reed
In the matter of the Estate of E. A. Green
deceased, for Letters of Administration

To the Hon. W. M. Ayres Judge of the County Court
of Champaign County, in the State of Illinois.

The Petition of the undersigned, Thos. A. Reed
respectfully represents that E. A. Green late of the
County of Champaign aforesaid, departed this life at Champaign, Ill.
in said County, on or about the 27th day of April
A. D. 1870, leaving no last will and testament as far as your petitioner know or believe.

And this Petition further shows that the said E. A. Green
died, seized and possessed of Real and Personal Estate, consisting chiefly of
Household & Kitchen Furniture also Real Estate
as follows - lots Eight & Nine & Twelve in Block Twelve and
lot Two Block Eleven situate in Urbana also lot No one
in Block Two in Campbell Third District, add. to Urbana and lot
No 22 of a subdivision of lot No 1 of the S. W. 1/4 of Sec. 19 N
R. 9 East - and lot No one hundred & thirty one of a subdivision of the N
1/4 of lot 2 of the Town of Orange aforesaid all lying in the County of Champaign
State of Illinois
all of said personal estate being estimated to be worth about Two hundred dollars
dollars. That said deceased left surviving him
Eva Green his widow, and Anna A. Green
Glenn E. Green and Gertrude J. Green

his children, as heirs. That your petitioner (being the share of the
Widow of said deceased, and) believing that the said estate should be immediately
administered, as well for the proper management of said estate
as for the prompt collection of the assets, by virtue of his right under the Statute
therefore pray that your honor will grant Letters of Administration to him
Thos. A. Reed in the premises, upon his taking the oath prescribed
by the Statute, and entering into bond in such sum, and with securities, as may be approved by
your honor.

STATE OF ILLINOIS.

Champaign COUNTY. } Thos. A. Reed

being duly sworn, depose and says, that the facts averred in the above petition are true, accord-
ing to the best of his knowledge, information and belief.

Sworn to and subscribed before me,

Clerk of the County Court of _____
County, this 24 day of _____
1870 A. D. 1860

W. M. Shuck CLERK.

Thos. A. Reed

Estate of E. A. Green Deceased.
 STATE OF ILLINOIS,)
 COUNTY OF Wau) ss. Wawa Green Widow
 of E. A. Green deceased, do hereby relinquish all my claim
 to the following articles, mentioned in the "Appraiser's estimate of specific property," allowed me for myself and family,
 to wit:

ITEMS	DOLLARS.	CENTS.	ITEMS	DOLLARS.	CENTS.
Necessary Beds, Bedsteads and Bedding for the widow and family.....	1.00	00	Amount brought forward.....	4.26	00
Necessary Household and Kitchen Furniture.....	1.50	00	One Horse.....	40	00
One Spinning Wheel.....	5	00	One Woman's Saddle and Bridle.....	15	00
One Loom and its Appendages.....	1.00	00	Provisions for one year.....	2.50	00
One Pair Cards.....	1	00	Sheep and Fleeces, being two for each member of the family.....	18	00
One Stove and necessary Pipe therefor.....	1.00	00	Food for the above Stock six months.....	25	00
Wearing Apparel for widow and family.....	1.00	00	Fuel for three months.....	1.00	00
Milk Cow and Cal. (being 1 for every 4 in the family.....)	5.00	00	Other Property.....	60	00
AMOUNT.....	4.26	00	TOTAL.....	889	00

The aggregate value of which, as estimated is Eight Hundred & Eighty Nine dollars, (\$ 889⁰⁰) and in lieu of the same I desire to retain the following articles named in the "Appraisal Bill of Personal Property" of said E. A. Green deceased, viz:

ARTICLES	VALUE	ARTICLES	VALUE
	DOLLS. CTS.		DOLLS. CTS.
1 Parlor Stove & Pipe	7 00	Amount brought forward,	168 75
1 Rooking Chair	4 00	1 Set Books	2 00
1 Set Bone bottom Chair	8 00	1 Cow	40 00
1 Center Table	15 00	1 Work Bench	1 00
1 Leaf Stand	4 00	1 Spade Hoe	1 00
1 Dining Table	5 00		
1 Cook Stove & Furnace	15 00		
1 Safe Wooden Box	3 00		
30 yds Hoopless Carpet	3 00		
10 " Rag Carpet	2 00		
1 Bed Room Bedstead & Bedding	3 00		
1 Set Greenware	1 00		
4 Hand Saws	5 00		
1 Tenon - do	1 00		
33 Small planes	20 00		
8 Large do	15 00		
1 Tool chest & other Tools	15 00		
1 Grind Stone	1 00		
1 Set Drill - cans	2 00		
1 Old Cook Stove	3 00		
1 Copper Kettle	2 00		
1 Pitcher	75		
1 Copy American Stationer	3 00		
Amount carried forward.	168 75		

The total value of which as appraised is \$ 212.75
Two Hundred Twelve Dollars & 75⁰⁰ Dollars, and the balance Eighty Seven Dollars & 75⁰⁰
87⁷⁵ Dollars, (\$ 87⁷⁵) I prefer to have in money.
 Witness my hand and Seal, this Twenty Second day of June
 A. D. 1890

E. A. Green 

9. Green died leaving a number of outstanding bills to local merchants unpaid. Since there was not enough ready cash, part of his land had to be sold to settle these debts. In late 1871 Green's daughters Anna and Florence petitioned that this be done. By this time they had moved to Fayette County, Ohio. Since they were born in that state, this locality might provide a clue for locating the family's whereabouts prior to coming to Champaign County and the identity of their mother.

State of Illinois, } led the County Court,
Champaign County } To the November Term
A.D. 1871.

Thomas A. Rees, Administrator of the Estate of
E. A. Green deceased -
vs.
Eva Green
Annie A. Green
Florence E. Green
Gertrude E. Green } Application to sell
land to pay debts.
Entry of appearance.

x
The Annie A. Green came
Florence E. Green, residents of the State
of Ohio, hereby waive notice of summons
or publication of the application of Tho.
A. Rees Administrator of the Estate of
E. A. Green to sell real estate of said
E. A. Green to pay debts, and hereby enter
an appearance as defendant, to said
suit done this 30th day of October
A.D. 1871. x

+ Annie A. Green
+ Florence E. Green

State of Ohio }
Fayette Co } Before me Manfred Willard
a Notary Public in and for the
County & State aforesaid personally
appeared Annie A. Green & Florence E.
Green and acknowledged the signing of
the within instrument to be their voluntary
act & deed for the uses and purposes
therein mentioned given under my hands
& official seal this 30th day of October
A.D. 1871 Manfred Willard

10. In 1872 some of Edward Green's land is sold. Generally it was unusual to see women's names as land purchasers, so one wonders somewhat at the fact that the parcels were sold to Harriet Stipes and Ann Weir.

	Elizabeth		Marrett C. Eaton	1875	3 270		20
	Elizabeth		Marrett C. Eaton	1875	70 3170		30
	Elizabeth		Marrett C. Eaton	1875	3 171		30
	Elizabeth		Francis M. Meadows	1875	11 6 71 11	11 70 10 2 3 4 5	30
	Elizabeth		Francis M. Meadows	1875	10 31 71		30
	Elizabeth		Francis M. Meadows	1875	11 16 71	11 70 10 2 3 4 5	340
	Elizabeth		Francis M. Meadows	1875	9 3 70		36
	Elizabeth		Archibald	1875	11 8 72	11 70 10 2 3 4 5	37
	Elizabeth		David J. Plate	1875	12 17 70		36
	Elizabeth		David J. Plate	1875	2 5 72	11 70 10 2 3 4 5	3 11
	Elizabeth		David J. Plate	1875	1 7 72		34
Green	Edward		Marrett C. Eaton	1875	3 17 72	3 4 5 6 7 8 9 10 11 12 13 14 15 16 17 18 19 20 21 22 23 24 25 26 27 28 29 30 31 32 33 34 35 36 37 38 39 40 41 42 43 44 45 46 47 48 49 50 51 52 53 54 55 56 57 58 59 60 61 62 63 64 65 66 67 68 69 70 71 72 73 74 75 76 77 78 79 80 81 82 83 84 85 86 87 88 89 90 91 92 93 94 95 96 97 98 99 100	20
	Edward		Ann	1875	3 17 72		24
	Edward		Ann	1875	3 17 72	11 70 10 2 3 4 5	1 100 100
	Edward		Ann	1875	4 17 72		26
	Edward		Ann	1875	5 2 72	11 70 10 2 3 4 5	1 13 100 100
	Edward		Ann	1875	6 14 72		27
	Edward		Ann	1875	11 24 72	11 70 10 2 3 4 5	20
	Edward		Ann	1875	11 16 72		25
	Edward		Ann	1875	2 20 72	11 70 10 2 3 4 5	3 11
	Edward		Ann	1875	3 1 71		25
	Edward		Ann	1875	5 20 72	11 70 10 2 3 4 5	3 11
	Edward		Ann	1875	4 16 72		27
	Edward		Ann	1875	5 17 72	3 4 5 6 7 8 9 10 11 12 13 14 15 16 17 18 19 20 21 22 23 24 25 26 27 28 29 30 31 32 33 34 35 36 37 38 39 40 41 42 43 44 45 46 47 48 49 50 51 52 53 54 55 56 57 58 59 60 61 62 63 64 65 66 67 68 69 70 71 72 73 74 75 76 77 78 79 80 81 82 83 84 85 86 87 88 89 90 91 92 93 94 95 96 97 98 99 100	1 11

11. Late that same year Eva Green marries Charles Lewis.

MARRIAGE LICENSE.

STATE OF ILLINOIS, CHAMPAIGN COUNTY.

The People of the State of Illinois,

To any Person Legally Authorized to Solemnize Marriage--Greeting:

You are Hereby authorized To join in the Holy Bands of Matrimony and Celebrate the Rites and Ceremonies of Marriage between Mr. Charles Lewis and Mrs. Eva Green according to the usual custom and Laws of the State of Illinois, and you are required to return this License to me within thirty days from the celebration of such Marriage, with a Certificate of the same appended thereto and signed by you, under the Penalty of One Hundred Dollars.

In Testimony Whereof, I have hereunto set my hand and the Seal of said County,

this 29th day of April A. D. 1872

J. H. Shuck

County Clerk.

Flynn & Seeger, Printers and Bookbinders, Urbana, Ill.

State of Illinois,

CHAMPAIGN COUNTY.

I, the undersigned Minister of the Gospel, do hereby certify that on the 1st day of December 1872 I joined in Marriage Mr. Charles Lewis with Mrs. Eva Green agreeably to the authority given in the above License, and the custom and laws of this State. Given under my hand and seal, this 2nd day of December A. D. 1872

Henry J. Smith

Seal.

2933

12. In 1874 Eva Lewis, formerly Eva Green, applied to become the legal guardian of her daughter Gertrude, age 4. From this document we learn the exact birthdate of the little girl, and that the family still owns property in which she has a one-third interest.

13. In 1876, Green's two eldest daughters petition for a partitioning of the remaining property (consisting of four lots) in which they each have a one-third share. The lots are assessed at \$100 each. By this time daughter Florence, now calling herself Flora, has married a man named Anderson. It is not specified where the two women were living, other than that they were not residents of Champaign County. An appraiser gave the opinion that the property could not be divided 3 ways without it being detrimental to the heirs. This case drags out over several years, during which time the value of the land is reduced to \$25 per lot. Finally the case is stricken from the court calendar.

State of Illinois, In the Circuit Court
Champaign County vs the September term 1876

Annie A. Green
Dora E. Anderson } Plaintiffs
vs
Gertrude L. Green }

This day came
again the petitioners by Langley Haight
their attorney and the infant Defendant
Gertrude L. Green by John Ray her guardian
ad litem. And the said J. S. Wright and John
Mass. two of said Commissioners appointed
herein by the Court to make partition of the
Real Estate hereinbefore mentioned made
report that said premises are so circum-
-stances that a division thereof can
not be made without manifest
prejudice to the parties interested. And that
the fair appraised value of each piece
or parcel of said premises is as follows
to-wit:

Lot 8, Block 12, Quincy added to Urbana.	\$ 100
" 9 " " " " " "	\$ 100
" 12 " " " " " "	\$ 1000
" 2 " " " " " "	\$ 100

And the Court having examined said report
doth find that said Commissioners herein
in all respects proceeded in accordance
with the law and the terms of the decree
under which they were appointed. And the

14. In June 1878 Eva Lewis gives birth to a stillborn son. The record of this event states that she was born in Iowa and gives a spelling variant of her last name. The attendant at this birth was Dr. H.C. Howard, for whom a Champaign school is named.

BIRTH RECORD

REEL 1295-929 # 21

Lewis, (Infant)

sex, M, birth order -

born 22 June 1878 (stillborn: * Black 7th mo)

father Charles Lewis

born - age -

mother Eva De Rous

born IA age -

attendant: H.C. Howard

Book 1 p. 152

Bu: ?

(res. 2d Ward, Champ.

15. The 1880 census gives valuable information about the Charles Lewis household. The birthplace of barber Charles and his parents is given as North Carolina. Eva, still a hairdresser, has only aged 8 years since the last census. Her father is listed as having been born in France, which is consistent with her surname; her mother's birthplace is given as South Carolina. The couple has 2 young sons, in addition to 10-year-old Gertrude. Note that in this census Eva and Gertrude are listed as mulattoes, whereas in 1870 they were designated as blacks. Leopold also remains in the household, but his origins remain clouded. Listed as Charles' stepson, his father's place of birth is given as North Carolina, which fits Edward A. Green's birthplace, but we know he wasn't Edward's son. His mother was supposedly born in France, which deepens the mystery.

Page No. 4

Supervisor's Dist. No. 5

Enumeration Dist. No. 3

Note A.—The Census Year begins June 1, 1870, and ends May 31, 1880.

Note B.—All persons will be included in the Enumeration who were living on the 1st day of June, 1880. No others will. Children BORN SINCE June 1, 1880, will be OMITTED. Members of Families who have DIED SINCE June 1, 1880, will be INCLUDED.

Note C.—Questions Nos. 18, 19, 22 and 23 are not to be asked in respect to persons under 10 years of age.

SCHEDULE I.—Inhabitants in Champaign in the County of Champaign, State of Illinois enumerated by me on the Fourth day of June, 1880.

G. W. Moore

Name of Person. Usual Surname.	In Cities.	Name of Person whose place of abode, on 1st day of June, 1880, was in this family.	Sex—Male, M.; Female, F. Age at last birthday prior to June 1, 1880. If under 1 year, give in months, thus: 7.	Relationship of each person to the head of this family: whether wife, son, daughter, servant, boarder, or other.	Color—White, W.; Black, B.; Mexican, M.; Chinese, C.; Indian, I.	Civil Condition.				Profession, Occupation or Trade of each person, male or female.	If the person (on the day of the Enumeration's visit) sick or temporarily disabled, so as to be unable to attend to ordinary business or duties? If so, what is the sickness or disability?	Health.				Education.			Nativity.		
						Single, /	Married, /	Widowed, /	Married during Census year, /			Blind, /	Deaf and dumb, /	Idiotic, /	Lunatic, /	Attended school within the Census year, /	Attended school within the Census year, /	Attended school within the Census year, /	Place of Birth of this person, naming State or Territory of United States, or the Country, if of foreign birth.	Place of Birth of the Father of this person, naming the State or Territory of United States, or the Country, if of foreign birth.	Place of Birth of the Mother of this person, naming the State or Territory of United States, or the Country, if of foreign birth.
<u>Watson James</u>			<u>M</u>	<u>63</u>	<u>White</u>					<u>Laborer</u>							<u>Penn</u>	<u>Penn</u>	<u>Penn</u>		
<u>Lewis Charles</u>			<u>B</u>	<u>32</u>	<u>White</u>					<u>Barber</u>							<u>N.C.</u>	<u>N.C.</u>	<u>N.C.</u>		
<u>— Eva</u>			<u>W</u>	<u>130</u>	<u>White</u>					<u>Wife</u>							<u>Ills</u>	<u>France</u>	<u>S.C.</u>		
<u>— Leonard W.</u>			<u>B</u>	<u>6</u>	<u>White</u>					<u>son</u>							<u>Ills</u>	<u>N.C.</u>	<u>Ills</u>		
<u>— Frank</u>			<u>B</u>	<u>4</u>	<u>White</u>					<u>son</u>							<u>Ills</u>	<u>N.C.</u>	<u>Ills</u>		
<u>Green Gertrude G.</u>			<u>W</u>	<u>10</u>	<u>White</u>					<u>daughter</u>							<u>Ills</u>	<u>N.C.</u>	<u>Ills</u>		
<u>Hinds Laura</u>			<u>B</u>	<u>11</u>	<u>White</u>					<u>Servant</u>							<u>Mo</u>	<u>Mo</u>	<u>Mo</u>		
<u>Green Sophia H.</u>			<u>W</u>	<u>19</u>	<u>White</u>					<u>step son</u>							<u>Ills</u>	<u>N.C.</u>	<u>France</u>		

16. In 1885 Charles Lewis is listed in the county directory. His barbershop is located in downtown Champaign; his place of residence is on the southwest corner of University and Third, the present location of Champaign Mattress Company.

Lester B P, rooms in Larned block up stairs.
 Levering Frank, with B T & M.
 Levernway John, rooms Harmon block up stairs.
 Levernway Henry, condr I C, r w s Market 5 s Springfield.
 Lewis Ed, student Ills University.
 Lewis C (c), barber, basement 25 Main, r sw cor University and 3d.
 Lewis D W, civil eng, n s Park 2 e Randolph.
 Lewerenz Chris, clk, r cor 1st and street car track.
 Lipe C O, clk Stern's, cor Randolph and Church.
 Link Luther, condr I C, r nw cor Church and 5th.
 Linnamen A, saddler, wks G E Hessel & Son, r Urbana.
 Lockwood W P, freight and ticket agt I B & W r r, r s s Washington 3 w State.
 Logan Harry, carpenter, bds Champaign house.
 Logan Robt, (c), f, 100 Springfield.
 Lloyde D H & Son, No 9 Main, New Home sewing machine and dealers in books and music, r n s Clark 2 w Randolph.
 Lloyde F H, r ne cor White and Prairie.
 Lloyde Clarence, student Ills University, r n s Clark 2 w Randolph.
 Lorenz John A C, ret, n s Columbia 3 w Prairie.
 Longdon Geo, farmer, r e s Lynn 2 s Washington.
 Loper Geo W, carpenter, r 21 Springfield ave.
 Loper D S, f, r 21 Springfield ave.
 Loper David H Jr, constable, r 21 Springfield ave.
 Loper D H Sr, ret, r 21 Springfield ave.
 Lumley Clinton, student Illinois University.
 Lutheran church, Rev Louis Friese pastor, nw cor 4th and University avenue.
 Lutz John Sr, lab, r Park bet 5th and 6th n s.
 Lutz John Jr, r n s Park bet 5th and 6th.
 Lutz David, lab, r n s Park bet 5th and 6th.
 Lynch John, clerk H K & Co, r ne cor Grove and 2d.
 Lynch Thos, student St Mary's school, ne cor Grove and 2d.
 Lynch Barney, lab, I C r r, r ne cor Grove and 2d.
 Lyons Pat, farmer, e I C near city limits.

MADDEN J D, auctioneer, commission, gen produce and poultry, 72 and 74 Neil st, r n Neil 6 d n I B & W.
 Madden Harry, lab, r 18 Hill.
 Madenwald Frank, carpenter, r w s Randolph 2 d n Green.

17. In November 1887 Gertrude Green comes of age. The following year the remaining 3 parcels of land are put up for sale for non-payment of taxes. However, the land is not redeemed and Gertrude, as an assignee of M. S. Parks, now obtains sole ownership of the land.

STATE OF ILLINOIS,
CHAMPAIGN COUNTY,

Whereas, at a public sale of real estate for the non-payment of taxes, made in the County aforesaid, on the 11th day of June, A. D. 1890, the following described real estate was sold, to-wit:

Lots 8-9-^{3rd} 12 in Block 12 in the Seminary addition to the town of Urbana

17. Grantee Index to Deeds, "Green"; Deed book 62, page 198

Situated in Champaign County and State of Illinois

And whereas, the same not having been redeemed from said sale, and it appearing that the holder of the certificate of purchase of said real estate has complied with the laws of the State of Illinois necessary to entitle her to a deed of said real estate:

Now, Therefore, Know Ye, that I J. S. McCullough County Clerk of said County of Champaign, in consideration of the premises and by virtue of the Statutes of the State of Illinois in such cases provided, do hereby grant and convey unto Gertrude L. Green assee of

M. S. Parke

heirs and assigns forever, the said real estate hereinbefore described, subject, however, to any redemption provided by law.

Given under my hand and the seal of our Court, this 24th day of June

A. D. 1890.



J. S. McCullough County Clerk.

Filed for Record, this 24th day of June, A. D. 1890 at 9 o'clock A. M. W. G. Brown Recorder.

Green	Gertrude L. Green	Geo W	Robert Fisher	Geo W	10000	723	4 Fisher
			J. B. Venable	Geo W	7500	46	"
			Geo L. Beardsley	Geo W	4500	70	Fisher lot 11 - rec'd! M + High
			Co. Clerk	Geo W	470	72	Fisher
			Geo L. Beardsley	Geo W	4400	44	Fisher

18. In 1890 Charles' listing is nearly the same as five years earlier. We find Leonard listed as a student, probably at Champaign High School.

visible, and having the being strung together. Instantly having it altered, its brilliancy and value of larger diamonds in all ones. There are some in the family, but no members are much about display, are occasions, these jew-

ector Byrnes' detectives, full evening dress in a room on the crest of Murchison, where Mrs. Astor and of New York were present. There is nearly five million of jewelry and precious stones. Valuable gems glittered in the gas light like the sun.—Foster Coates in Journal.

Use for Coal Gas.
 English technical journal states now that the electric is rapidly supplanting gas, and is eagerly searching for new uses for the older illuminant. As a heating agent it is perfect, and the by-products are reduced to an astonishing extent. The utility of the asphyxiating gas, the monoxide of carbon, is frequently poisoned by the alcohol. It is suggested as a solution of the problem—the humane execution of

o Jail in Ireland.
 Irish woman, bright, witty, and an educated Irish woman being. She was telling me in a certain hotel parlor. Isle soon after one of the marriages among the Irish

field, Ill., Nov. 18 to 22.
 For the above occasion the Wabash will sell tickets to Springfield and return at one and one third fare on the certificate plan. For tickets and certificates apply at the Wabash ticket office, J. H. Hitt agent. d&wtonov22.

Diamonds and Watches sold on monthly payments by Zi Riley. d&wtf

Zi Riley makes a specialty of fitting spectacles and eye glasses. d&wtf

MRS. E. LEWIS,

THE FASHIONABLE

Hair Dresser,

27 MAIN STREET,

has the largest stock of Ladies' Hair Goods, and offered at the lowest prices. Also the Perfection of Golden Blond Bleach, Curling Fluid, Cold Creams and Powders for the Skin. A Tooth Soap that beautifies the teeth and perfumes the breath. All kinds Curling Irons, Crimping Pins, Kid Rollers and ornaments for the hair Cutting Bang and Curling a specialty

New Cash Grocery.

I have opened a Complete line of Groceries, all New, and of the Best Quality, in the basement of the Walker opera-house, where I shall endeavor to sell goods as cheap as any in the city, and to deliver the same promptly. I also have a complete line of

Nuts,
Fruits.

Of Parlor Se
 Rookery
 sell the goods a
 turned out with

DROP
 on eve
FURY

we handle. W
 talk of advancin
 pared to push
 and Hold
 Everything sold

WALKER
 43 & 45
 dt

THE TYPE

\$20 will buy the O
 with 75 charac
GLE CASE ODE
 work than any machine
 It combines simplicity
 ease of operation, wear
 pairs than any other in
 both the operator. It
 plated, perfect and cheap
 ing. Like a printing p
 leather mechanism

Lehr Peter, r 23 E Springfield av
 Lechner C. A., foreman cigar mfg, r 401 W Clark
 Lemen Joseph R., blacksmith, r 105 W Hill
 Lemen Mary C. Mrs., boarding, 105 W Hill
 Leming Grant, carpenter, r 504 E Springfield av
 Lennington Allan S., clerk, r 303 N Prospect av
LENNINGTON GRANT E., boots and shoes, 19 Main, r 311
 W Columbia
 Lennington Wade, farmer, r 303 N Prospect av
 Lennington William H., r 303 N Prospect av
 Leonard Thomas, laborer, r 10 E Washington
 Leppert Lawrence, barkeeper, r 118 E University av
 Lettimore Samuel, blacksmith, r 601 S Wright
 Lever William, r nr extreme end S Neil, outside city limits
 Levernway Henry, conductor I. C. R. R., r 602 S State
 Levy Frank H., student, r 602 E Clark
 Levy J. T., grocer, r 602 E Clark
 Lewis Benjamin, laborer, bds 26 N Neil
 Lewis Charles, barber, 25 Main, 211 E University av
Lewis Elizabeth, wid John, r 505 Stoughton
Lewis Leonard, student, r 211 E University av
 Lewis Libbie Mrs., r 123 E University av
 Lewis Oscar D., clerk, r 123 E University av
 Lewis Sarah M., wid John R., r 720 W Church
 Lierman August, saloon, 110 N. First, r 11 N First
 Lilly Valeria G., wid Rev. R. H., r 505 N Prospect av.
 Lindemann William, painter, bds Matheny's Hotel
 Linton William H., train dispatcher I. C. R. R., r 310 E White
 Lipe Amelia, wid Charles, r 92 Walnut
LITTLER FRANK H. (J. E. Littler & Bros.), r e of Urbana,
 nr city limits
LITTLER JOHN E. (J. E. Littler & Bros.), r 508 W White
LITTLER J. E. & BROS. (John E., Frank H. and Willis D.
 Littler), flour and feed, coal and farm machinery, Armory
 Building
LITTLER WILLIS D. (J. E. Littler & Bros.), r e of Urbana,
 nr city limits
 Lloyde David H. (D. H. Lloyde & Son), r 308 W Clark
LLOYDE-D. H. & SON (David H. and Frank H. Lloyde),
 books, music and stationery, 9 Main
 Lloyde Frank H. (D. H. Lloyde & Son), r 306 W Clark
 Lockwood, Frank M., student, r 307 W Washington
 Lockwood William P., agt C., C. C. & St. L. Ry., r 307 W
 Washington
 Loehner William, painter, r 106 Stoughton

19. In November 1890 Charles Lewis suffers a stroke and dies. His obituary too sheds some light on his background and affiliations.

Charles Lewis Dead.

Charles Lewis, the barber, who had a stroke of paralysis, as was stated in THE GAZETTE a few days ago, died at his home at the corner of University avenue and Third street, Saturday at 5 o'clock a. m. The news of his death was a shock to his many friends. He was forty-three years old, and was born in Goldsboro, North Carolina, but had been a resident of Champaign for a great many years. His funeral occurred on Monday afternoon at one o'clock from the African M. E. church, and was conducted by the A. F. and A. M. lodge, of which order he was a member of high standing.

20. When Charles Lewis' estate is probated, his widow, Eva, is named administrator. She, Leonard and Frank are named as heirs. Charles' property is much more modest than that of his predecessor, mainly consisting of barbershop furnishings, and his widow is granted everything in the estate to cover her dower rights. Charles Lewis and E.A. Green died before death certificates were mandatory. Their resting places are unknown.

Petition of *Eva Lewis*
In the matter of the Estate of *Charles Lewis*
deceased, for Letters of Administration

To the Hon. *W. C. Staley* Judge of the County Court
of Champaign County, in the State of Illinois.

The petition of the undersigned, *Eva Lewis*
respectfully represents that *Charles Lewis* late of the
County of *Champaign* aforesaid, departed this life at *Champaign*
in said County, on or about the *Twentieth* day of *November*

A. D. 1890 leaving no last will and testament as far as your petitioner knows or believes,

And this Petition further shows that the said *Charles Lewis*
died, seized and possessed of ~~the~~ Personal Estate, consisting chiefly of *One Barber
Shop containing four Barber Chairs
and other necessary fixtures all
contained in premises rented of
H. B. Mc Kinley situated on the
corner of Wash & Walnut Streets
Champaign Illinois*

all of said personal estate being estimated to be worth about *Two Hundred
Fifty* dollars. That said deceased left surviving him

Eva Lewis his widow, and *Leonard Lewis,
aged seventeen years and Frank
Lewis, aged fifteen years*
his children, as heirs. That your petitioner (being *the widow*

of said deceased, and) believing that the said estate should be immediately administered, as
well for the proper management of said *personal estate*

as for the prompt collection of the assets, by virtue of *her* right under the Statute *she*
therefore prays that your honor will grant Letters of Administration to *her the said Eva Lewis*

in the premises, upon *her* taking the oath prescribed by the Statute, and entering into bond in
such sum, and with securities, as may be approved by your honor. *Eva Lewis*

STATE OF ILLINOIS, }
CHAMPAIGN COUNTY, } ss. *Eva Lewis*

being duly sworn, deposes and says, that the facts averred in the above petition are true, according to the best of
her knowledge, information and belief.

Sworn to and Subscribed before me.

Clerk of the County Court of Champaign County.

this *Eighth* day of
January A. D. 1891
Hubert Gray
Notary Public

Eva Lewis

21. In 1898 we find the last mention of the Green-Lewis family in county records. Gertrude signs a quit-claim deed for her property in favor of her mother in exchange for \$1. The following day Eva Lewis sells the same property to Perry C. Johnson for \$850.

The Gazette.

LOCAL BREVITIES.

Old Charles and Arch McFadden are in Tuscola.

George Thorpe now drives Henry's west side wagon.

Mrs. W. H. Smith is in Decatur visiting Mrs. H. C. Johns.

Lewis Johnson, a colored boy is nearly dead at his home from scrofula.

Mr. and Mrs. Emmons Davis, of Filley, Nebraska, are guests of Mr. and Mrs. G. R. Gamble.

Mrs. J. R. Lemon went to Chicago today, where she will visit the family of Samuel Doyle.

"One of the Finest" was given to a good audience Thursday night. The company was well received.

Mrs. M. A. O. Kincaid and daughter have returned from a visit with relatives at Cleveland, Ohio.

The paving of Market street, between University avenue and Main street is about half completed.

A. V. Miller went to Chicago this morning, to purchase goods for E. Miller & Son's dry goods house.

Onas Lewis, the barber, who was paralyzed yesterday, is somewhat improved, but has no use of his body.

Master George Fisher entertained a party of young friends Thursday evening, the occasion being his birthday.

The stars and stripes now float over the public school buildings in Danville. Such a step should be taken in this city.

Schweizer & Woody's new building is rapidly nearing completion, and will be

parents, and is a demonstration of the esteem in which they are held by the class.

Did you notice the earth shake yesterday? John L. Sullivan was in town. Not that real, genuine John, but a man who looks exactly like him, walks like him and talks like him. Curious people hung around the Carter house all day, trying to get a look at him, and when he went to the train he was followed by quite a crowd. The correct image of the great slugger was F. H. Bunny, a traveling salesman from Philadelphia. He said to a reporter: "Everywhere I go where I am not known, I am taken for Sullivan. Just the other day I made the town of Litchfield, in the southern part of the state, and in about an hour after my arrival the news flew like dust on a windy day, that the great Bostonian was in town. Crowds began to swarm around the hotel where I was stopping, and when I had to go out to see my customers I was followed by scores of people, and when I went to leave the town I think there were two hundred people at the train to see me off."

Chicago has a Big 4, engaged in the hog business; and now behold Urbana had developed a Big 4, composed of Wright, Besore, Oall and Heller, who not only are using their best efforts to keep down improvements in Urbana, but have taken it upon themselves to dictate that Champaign shall have neither electric railway nor electric lights. Fortunately, these men are not representative men of Urbana, and their only power is a little brief authority given some of them in the city council.

The annual ball of Division, No. 1, A. O. H., will be held in the Walker opera-house on Wednesday evening of next

A BOARDER'S TROUBLES.

Mistaken for a Burglar, He is Pounded Upon by Twoirate Females.

Last night about nine o'clock a GAZETTE man was walking on a principal avenue, and was startled to hear the cries of "Murder, murder, fire, burglars, police, police," by a woman, or rather two women, but from the noise anyone would have been led to believe that it was a dozen women. Immediately the newspaper man ran back, not because there was some show of an item in it, but thinking that his services might be of assistance. The house was soon located, and the reporter started around the side when a man came darting towards him. The pencil-pusher was rather excited at first, but through the habit of grabbing onto rapidly moving things, he found himself in an instant tightly clutching the supposed robber and both were struggling to the ground. In hot pursuit came the women who had a few seconds before made the night hideous by their screams, one armed with an old hatchet, the other having a fine specimen of a poker. "Kill him," one cried, but the other suggested that he be held until she could run and bring a policeman. She hurried off down the street, and the reporter and remaining female both sat on the supposed burglar, the latter holding her implement of warfare—the hatchet—over the unfortunate fellow's head, and informing him the first move he made his brains would be forcibly removed, as she was somewhat on pounding beef-steak. After a few minutes the poor mortal, who thought his last hour had come, had regained sufficient wind to speak, and his would-be slayer immediately recognized his voice. She dropped her weapon and

A SHOOTING

Grant Vaughn, a Barber His How

Last night several peborhood of the gas hot from their rest by several revolvers, and the trouble the house of Grant Vaughn, a colored barber, and a low. He is employed at a shop. After his day's last night he started to 210 East Park street, the house he was met by who had just stepped out of bed-room. The white fellow Vaughn, who returned through two or three shots. Th to the sidewalk, the end his heels, but could Vaughn thinks, however balls took effect in the had a warrant issued for morning, which was put Conatable Loper, who beat his man. His name was

Posten Gets St

JACKSONVILLE, Ill., Posten, the colored coach murderous assault on a man in this city a year found guilty on one day and sent to the penitentiary for years. The indictment charging shooting Ralph Bancroft who tried to defend Mitchell. Posten will next morning go still harder with

That Rascal

NEW YORK, Nov. 21.—The creditors of Smith, the assignee of the firm & Co. at the offices of J

anager.

24.

okett.

The Original and Only Davy Crockett.

okett:

d Seats

o.

W.N.

words of one cent value.

TO D street.

WORK sa, or at a. 8636

ENTLE Call at rest, Ur- 8436

BURCH

CHAMPAIGN, ILLINOIS, THURSDAY, NOVEMBER 20, 1890.

Gazette.

EVITIES.
den, is visiting in
d to the house with
g his daughter, Mrs.
on.
Bloomington Pant-
Wednesday.
of Smith Brothers'
Paxton today.
number 9—made its
ctric road yesterday.
of Penfield, is visit-
ohn Melahn, in this
rned from Decatur
visiting his brother
was looked up in
light for disorderly
in Springfield, at-
of the Odd-fellows
Hammond, an old
is here visiting his
wife returned yes-
, where they have
ife, who have been
city, have returned

This morning Charles Lewis, the barber, had a stroke of paralysis at his shop. He felt in as good health when he arose from bed, and got to his shop about seven o'clock. Just as he entered the door he was taken by a pain in the left side of his head, which extended to his foot. He hallowed, and one of his barbers ran to his side just in time to keep him from falling to the floor. He was carried to a chair and a carriage called, which took him to his home. A physician was called, who did all he could for the man. He is perfectly helpless, but has no pain.

Following is what the Omaha Herald says of Miss Stevens: "Her playing is marked by that grand breadth and dignity and majestic repose so characteristic of the Liszt school. She possesses the fire, brilliancy and daring that is not usually found in so young an artist." This talented lady will be at the Congregational church on next Monday evening.

The Ogden, Utah, Commercial says: "Mr. C. H. Nicolet, auditor of the Bear Lake and River Water-works and Irrigation company, and wife are rejoicing over the advent of a daughter of the average weight. The young lady arrived Thursday at 11 p. m." Mr. Nicolet is a son of City Clerk Nicolet.

J. D. Madden went to Chicago yesterday to meet his wife, who has been visiting the family of her son, J. F. Bradley, in Oregon, for several weeks. Mrs. Madden was accompanied home by Mr. Bradley

CARNIVAL OF THE MONTHS.

Additional Notes Regarding It—A Most Gratifying Success.

The ladies of the First Methodist Episcopal church are quite pleased over the result of their entertainment on Tuesday evening. A partial notice of the result was given yesterday, but the ladies find, as they gather up the fragments, that their receipts are even greater than reported yesterday.

Nearly five hundred dollars was taken in, and over four hundred dollars will be cleared. This fund is for the use of the parsonage committee. Mrs. F. J. Smith, who is chairman of this committee, managed the entertainment, together with Mrs. H. J. Pepper. These ladies, of course, had the co-operation of many other members of the society, both men and women.

The city orchestra, which rendered the good music, gave their services free to the society, and have their grateful thanks.

Mr. W. P. Lockwood, as Santa Claus, deserves especial mention. His headquarters were in the December booth, which was most beautifully arranged, and universally admired. It was presided over by Mrs. Pepper.

Santa Claus distinguished himself in leading the grand march. Following in his train were: the parties from the different booths; Uncle Sam, with his gorgeous suit; the Goddess of Liberty, carrying the flag; Mr. Fred Hessel and Mr. H. J. Pepper, representing the longest and

ANOTHER BIG INDUSTRY.

The Gullick Tailoring Establishment, and The Hands Employed.

Everyone knows where the Gullick Tailoring company carries on business, and but few people know the number of hands that flock into the factory every morning as the whistles are blowing for seven o'clock; and as the GAZETTE has commenced a "write-up" of Champaign's leading industries, this concern was chosen as the next following the Empire Cordage company. Mr. Gulick, the manager, has for many years carried on the same kind of business in Rantoul, but the fast growth of trade made it inconvenient for him in so small a town. He therefore decided to move to Urbana, which he did over a year ago, where he remained until he saw that he could do a larger business if he would move his factory to this city, and he at once began the search for a piece of ground on which to erect a suitable building for his business. This he got on Main street, just east of and adjoining the Behrens block, where he erected a brick store and factory 48x100 feet. The building was so planned that he could use it as a factory and also a retail house. The front is of plate glass, giving him two entrances and four large show windows. His sales-room is in front, where he has a floor space of 48x56 feet, and immediately in the rear of this is the cutting department, where all garments are cut, which occupies a space of 16x48 feet. Directly back of this is the work-room, where the

The total Pacific rail government 563.

The next Brotherhood will be held 1892.

The reason sleeping car for tips lie their wages only.

It is said engineer of the on a railway Quebec, will scheme.

The railroad is said, soon a double pin York and I of small pie

General P Burlington system of produced in practicable

The estimate way from E stock, on the 400,000,000 Surveys are

The \$75,000 burg by the St. Louis rail and Trust c

GRANTOR INDEX CHAMPAIGN CO

GRANTOR	GRANTEE	DATE	AMOUNT	BOOK	PAGE
Maria E.	Richard Green	4 27 95	25	106	
Richard Green	Richard Green	5 14 95		32	
Richard Green	Richard Green	5 25 95		104	
Richard Green	Richard Green	5 27 95		104	
Richard Green	Richard Green	9 19 95		490	
Richard Green	Richard Green	9 18 95		490	
William Nelson Sr.	William Nelson Sr.	2 3 96	1000	107	
William Nelson Sr.	William Nelson Sr.	2 1 96	1000	31	
Harriet B. Schaefer	Harriet B. Schaefer	2 27 95	3000	105	
Harriet B. Schaefer	Harriet B. Schaefer	2 18 96	3000	361	
Harriet B. Schaefer	Harriet B. Schaefer	9 20 97	950	106	
Anna Morfe	Anna Morfe	9 18 97	950	405	
Dwight Green	Dwight Green	11 3 97	1450	107	
Dwight Green	Dwight Green	11 3 97	1450	360	
Samuel B. Lusk	Samuel B. Lusk	1 15 96	200	110	
Samuel B. Lusk	Samuel B. Lusk	10 25 97	200	189	
Anna C. Green	Anna C. Green	4 5 98	600	112	
Anna C. Green	Anna C. Green	4 6 98	600	131	
Eva Lewis	Eva Lewis	9 23 98	1	111	
Eva Lewis	Eva Lewis	10 5 98	1	344	

GRANTOR	GRANTEE	DATE	AMOUNT	BOOK	PAGE
Thomas B. Lewis	Thomas B. Lewis	5 16 95	1.00	106	
Thomas B. Lewis	Thomas B. Lewis	5 28 95	1.00	26	
J. K. Hughes	J. K. Hughes	6 17 95	115.00	101	
J. K. Hughes	J. K. Hughes	6 21 95	115.00	610	
William B. Fisher	William B. Fisher	6 4 98		113	
William B. Fisher	William B. Fisher	6 6 98	6170.00	84	
William B. Fisher	William B. Fisher	4 22 98		112	
William B. Fisher	William B. Fisher	7 30 98	200.00	242	
William B. Fisher	William B. Fisher	9 24 98		111	
Perry C. Johnson	Perry C. Johnson	10 5 98	850.00	313	
Perry C. Johnson	Perry C. Johnson	10 21 98		113	

22. Although the family disappeared from Champaign County records, it was possible to find out where they were living at the time of the next census. Using the index to the 1900 census, we find Eva Lewis living in Springfield, Illinois, with her 'foster-son' Leopold H., 'foster-daughter' Gertrude L., and a niece, Dora A. Williams. This census gives the month and year of birth of each individual listed. From here it would be possible to go to the actual census listing for additional information on household members. Using the census index it was also possible to learn that Leonard W. Lewis (and most likely his brother Frank as well) had migrated to Chicago. So it would be in Sangamon and Cook Counties where the thread for this family would be taken up for further research.

ILLINOIS

Lewis, Eva (HEAD OF FAMILY) VOL. *144* E.D. *97*
 SHEET *4* LINE *63*

B Dec 1848 51 Illinois
 (COLOR) (MONTH) (YEAR) (AGE) (BIRTHPLACE)
Springfield Capital Ave (COUNTY) (IN. C. D.) (STREET) (HOUSE NO.)
615

OTHER MEMBERS OF FAMILY

NAME	RELATIONSHIP	BIRTH		AGE	BIRTHPLACE	CITIZENSHIP
		MONTH	YEAR			
<i>Green, Leopold H</i>	<i>F. S.</i>	<i>Aug</i>	<i>1861</i>	<i>38</i>	<i>Illinois</i>	
<i>Hertude L</i>	<i>F. D.</i>	<i>Nov</i>	<i>1871</i>	<i>25</i>	<i>Illinois</i>	
<i>Williams, Dora A</i>	<i>Wife</i>	<i>Nov</i>	<i>1885</i>	<i>14</i>	<i>Missouri</i>	

1900 CENSUS—INDEX
 DEPARTMENT OF COMMERCE
 BUREAU OF THE CENSUS

A-18
 U. S. GOVERNMENT PRINTING OFFICE 11-11071

ILLINOIS

Lewis, Leonard W. (HEAD OF FAMILY) VOL. *28* E.D. *1027*
 SHEET *8* LINE *5*

B Apr 1872 26 Illinois
 (COLOR) (MONTH) (YEAR) (AGE) (BIRTHPLACE)
Chicago State (COUNTY) (IN. C. D.) (STREET) (HOUSE NO.)
4711

OTHER MEMBERS OF FAMILY

NAME	RELATIONSHIP	BIRTH		AGE	BIRTHPLACE	CITIZENSHIP
		MONTH	YEAR			
<i>Flora</i>						

1900 CENSUS—INDEX
 DEPARTMENT OF COMMERCE
 BUREAU OF THE CENSUS

A-18
 U. S. GOVERNMENT PRINTING OFFICE 11-11071

22. Soundex to the 1900 Federal Census, L200 (Lewis) and G540 (Green)

STREET	HOUSE NUMBER	LOCATOR	NAME	RELATION	PERSONAL DESCRIPTION													PLACE OF BIRTH OF FATHER	PLACE OF BIRTH OF THIS PERSON	NATIVITY
					1	2	3	4	5	6	7	8	9	10	11	12	13			
Street	House Number	Number of dwelling house, in the order of visitation	Number of family, in the order of visitation	of each person whose place of abode on June 1, 1900, was in this family. Enter surname first, then the given name and middle initial, if any. Indicate every person living on June 1, 1900. Omit children born since June 1, 1900.	Relationship of each person to the head of the family.	Color or race.	DATE OF BIRTH		Age at last birthday.	Whether single, married, widowed, or divorced.	Number of years married.	Mother of how many children.	Number of those children living.	Place of birth of father.	Place of birth of this person.	Place of birth of each person and parents of each person, give the State or Territory, if of foreign birth.				
Capital Ave	615	68	Williams, Mary A	Daughter	W	W	1871	29	21	0	0	0	0	Illinois	Illinois	Illinois				
Capital Ave	613	66	Williams, Mary A	Daughter	W	W	1871	29	21	0	0	0	0	Illinois	Illinois	Illinois				
Capital Ave	611	64	Williams, Mary A	Daughter	W	W	1871	29	21	0	0	0	0	Illinois	Illinois	Illinois				
Capital Ave	609	62	Williams, Mary A	Daughter	W	W	1871	29	21	0	0	0	0	Illinois	Illinois	Illinois				
Capital Ave	607	60	Williams, Mary A	Daughter	W	W	1871	29	21	0	0	0	0	Illinois	Illinois	Illinois				
Capital Ave	605	58	Williams, Mary A	Daughter	W	W	1871	29	21	0	0	0	0	Illinois	Illinois	Illinois				
Capital Ave	603	56	Williams, Mary A	Daughter	W	W	1871	29	21	0	0	0	0	Illinois	Illinois	Illinois				
Capital Ave	601	54	Williams, Mary A	Daughter	W	W	1871	29	21	0	0	0	0	Illinois	Illinois	Illinois				
Capital Ave	599	52	Williams, Mary A	Daughter	W	W	1871	29	21	0	0	0	0	Illinois	Illinois	Illinois				
Capital Ave	597	50	Williams, Mary A	Daughter	W	W	1871	29	21	0	0	0	0	Illinois	Illinois	Illinois				
Capital Ave	595	48	Williams, Mary A	Daughter	W	W	1871	29	21	0	0	0	0	Illinois	Illinois	Illinois				
Capital Ave	593	46	Williams, Mary A	Daughter	W	W	1871	29	21	0	0	0	0	Illinois	Illinois	Illinois				
Capital Ave	591	44	Williams, Mary A	Daughter	W	W	1871	29	21	0	0	0	0	Illinois	Illinois	Illinois				
Capital Ave	589	42	Williams, Mary A	Daughter	W	W	1871	29	21	0	0	0	0	Illinois	Illinois	Illinois				
Capital Ave	587	40	Williams, Mary A	Daughter	W	W	1871	29	21	0	0	0	0	Illinois	Illinois	Illinois				
Capital Ave	585	38	Williams, Mary A	Daughter	W	W	1871	29	21	0	0	0	0	Illinois	Illinois	Illinois				
Capital Ave	583	36	Williams, Mary A	Daughter	W	W	1871	29	21	0	0	0	0	Illinois	Illinois	Illinois				
Capital Ave	581	34	Williams, Mary A	Daughter	W	W	1871	29	21	0	0	0	0	Illinois	Illinois	Illinois				
Capital Ave	579	32	Williams, Mary A	Daughter	W	W	1871	29	21	0	0	0	0	Illinois	Illinois	Illinois				
Capital Ave	577	30	Williams, Mary A	Daughter	W	W	1871	29	21	0	0	0	0	Illinois	Illinois	Illinois				
Capital Ave	575	28	Williams, Mary A	Daughter	W	W	1871	29	21	0	0	0	0	Illinois	Illinois	Illinois				
Capital Ave	573	26	Williams, Mary A	Daughter	W	W	1871	29	21	0	0	0	0	Illinois	Illinois	Illinois				
Capital Ave	571	24	Williams, Mary A	Daughter	W	W	1871	29	21	0	0	0	0	Illinois	Illinois	Illinois				
Capital Ave	569	22	Williams, Mary A	Daughter	W	W	1871	29	21	0	0	0	0	Illinois	Illinois	Illinois				
Capital Ave	567	20	Williams, Mary A	Daughter	W	W	1871	29	21	0	0	0	0	Illinois	Illinois	Illinois				
Capital Ave	565	18	Williams, Mary A	Daughter	W	W	1871	29	21	0	0	0	0	Illinois	Illinois	Illinois				
Capital Ave	563	16	Williams, Mary A	Daughter	W	W	1871	29	21	0	0	0	0	Illinois	Illinois	Illinois				
Capital Ave	561	14	Williams, Mary A	Daughter	W	W	1871	29	21	0	0	0	0	Illinois	Illinois	Illinois				
Capital Ave	559	12	Williams, Mary A	Daughter	W	W	1871	29	21	0	0	0	0	Illinois	Illinois	Illinois				
Capital Ave	557	10	Williams, Mary A	Daughter	W	W	1871	29	21	0	0	0	0	Illinois	Illinois	Illinois				
Capital Ave	555	8	Williams, Mary A	Daughter	W	W	1871	29	21	0	0	0	0	Illinois	Illinois	Illinois				
Capital Ave	553	6	Williams, Mary A	Daughter	W	W	1871	29	21	0	0	0	0	Illinois	Illinois	Illinois				
Capital Ave	551	4	Williams, Mary A	Daughter	W	W	1871	29	21	0	0	0	0	Illinois	Illinois	Illinois				
Capital Ave	549	2	Williams, Mary A	Daughter	W	W	1871	29	21	0	0	0	0	Illinois	Illinois	Illinois				

FAMILY GROUP NO. Husband's Full Name EDWARD R GREEN IV

This information Obtained From:

Husband's Data	Day	Month	Year	City, Town or Place	County or Province, etc.	State or Country	Add. Info. on Husband
① 1860 Census - Champaign Co IL Hh # 2550-2460 Champaign			c 1812-20			NC	
② 1870 Census - Champaign Co IL Hh # 238-243 Champaign			< 1848			(OH.)	
③ Granite Indexes to Deeds			28 April 1870	Champaign		IL	

Places of Residence
Occupation Church Affiliation Military Rec.

Other wives, if any. No. (1) (2) etc. Make separate sheet for each marr.

His Father Mother's Maiden Name

Wife's Full Maiden Name ① ?

Wife's Data	Day	Month	Year	City, Town or Place	County or Province, etc.	State or Country	Add. Info. on Wife
Birth							
Chr'nd							
Death			between 1850-60				
Burial							

Compiler M. C. McNabb Places of Residence
Address Occupation Church Affiliation Military Rec.

City, State Other husbands, if any. No. (1) (2) etc. Make separate sheet for each marr.

Date Jan 16 1992 Her Father Mother's Maiden Name

Sex	Children's Names in Full (Arrange in order of birth)	Children's Data	Day	Month	Year	City, Town or Place	County or Province, etc.	State or Country	Add. Info. on Children
F	1 Anna A	Birth			c 1848			OH	
	Full Name of Spouse	Marr.							
		Death			1876+				
		Burial							
F	2 Florence E teacher	Birth			c 1849-50			OH	
	Full Name of Spouse Anderson	Marr.			< 1876	C Fayette		OH J	
		Death			1876+				
		Burial							
	3	Birth							
	Full Name of Spouse	Marr.							
		Death							
		Burial							
	4	Birth							
	Full Name of Spouse	Marr.							
		Death							
		Burial							
	5	Birth							
	Full Name of Spouse	Marr.							
		Death							
		Burial							
	6	Birth							
	Full Name of Spouse	Marr.							
		Death							
		Burial							
	7	Birth							
	Full Name of Spouse	Marr.							
		Death							
		Burial							
	8	Birth							
	Full Name of Spouse	Marr.							
		Death							
		Burial							
	9	Birth							
	Full Name of Spouse	Marr.							
		Death							
		Burial							
	10	Birth							
	Full Name of Spouse	Marr.							
		Death							
		Burial							

* For additional children use Everton Publishers' Children Continuation Sheet, Form A11

Form A1, Family Group Sheet by The Everton Publishers, P.O. Box 368, Logan, UT 84321. Publishers of The Genealogical Helper. Send for a free catalogue with list and full descriptions of many genealogical aids.

FAMILY GROUP NO.

Husband's Full Name ^① Edward A

GREEN

This information Obtained From:

	Husband's Data	Day	Month	Year	City, Town or Place	County or Province, etc.	State or Country	Add. Info. on Husband
① EAG obit. - Champaign Co. Gazette, May 1870	Birth	C	1812	20			NC	
② EAG-ED mar. certificate	Marr.	18	Sept	1865	Champaign		IL	
③ 1870 census - Champaign Co, IL Hh # 235-243	Death	28	April	1870	Champaign		IL	
	Burial							

④ Encumbrance - Grantor Indexes to Deeds

Places of Residence	Occupation	Church Affiliation	Military Rec.
	Carpenter		
Other wives, if any. No. (1) (2) etc. Make separate sheet for each marr. ① ?			
His Father		Mother's Maiden Name	

Wife's Full Maiden Name ^② Eva DEROUSSE

	Wife's Data	Day	Month	Year	City, Town or Place	County or Province, etc.	State or Country	Add. Info. on Wife
	Birth		Dec	1848			IL	
	Chr'nd							
	Death			1900+				
	Burial							

Compiler M. C. McNabb

Places of Residence	Occupation	Church Affiliation	Military Rec.
Other husbands, if any. No. (1) (2) etc. Make separate sheet for each marr. ② Charles Lewis (1 Dec 1872 - Champaign Co)			
Her Father		Mother's Maiden Name	

Address

City, State

Date

16 Jan 1992

Sex	Children's Names in Full (Arrange in order of birth)	Children's Data	Day	Month	Year	City, Town or Place	County or Province, etc.	State or Country	Add. info. on Children
F	1 Gertrude L	Birth	2	Nov	1869	Champaign		IL	
		Marr.							
	Full Name of Spouse	Death			1900+				
		Burial							
	2	Birth							
		Marr.							
	Full Name of Spouse	Death							
		Burial							
	3	Birth							
		Marr.							
	Full Name of Spouse	Death							
		Burial							
	4	Birth							
		Marr.							
	Full Name of Spouse	Death							
		Burial							
	5	Birth							
		Marr.							
	Full Name of Spouse	Death							
		Burial							
	6	Birth							
		Marr.							
	Full Name of Spouse	Death							
		Burial							
	7	Birth							
		Marr.							
	Full Name of Spouse	Death							
		Burial							
	8	Birth							
		Marr.							
	Full Name of Spouse	Death							
		Burial							
	9	Birth							
		Marr.							
	Full Name of Spouse	Death							
		Burial							
	10	Birth							
		Marr.							
	Full Name of Spouse	Death							
		Burial							

* For additional children use Everton Publishers' Children Continuation Sheet, Form A11

Form A11, Family Group Sheet by The Everton Publishers, P.O. Box 588, Everton, MA 01939. Send for a free catalogue with list and full descriptions of many genealogical aids.

Form A1, Family Group Sheet by The Everton Publishers, P.O. Box 368, Leport, UT 84321. Publisher of The Genealogical Helper. Send for a free catalogue with list and full descriptions of many genealogical aids.

FAMILY GROUP NO.

Husband's Full Name Charles

LEWIS

This information Obtained From:

	Husband's Data	Day Month Year	City, Town or Place	County or Province, etc.	State or Country	Add. Info. on Husband
① CL - EG mar. certif	Birth	c1877-8	Goldsboro		NC	
② 1880 Census Champaign Co IL - ED3 # 43-46	Chr'nd					
③ CL cert. Champaign Co. gazette" 26 Nov 1890	Marr.	1 Dec. 1872	Champaign		IL	
	Death	20 Nov. 1890	Champaign		IL	age 43; stroke
	Burial					

④ 1900 IL Soudex - (Saugamon Co IL)	Places of Residence			member A.F. & A.M. Lodge	
	Occupation	barber	Church Affiliation	A.M.E.	Military Rec.

Other wives, if any, No. (1) (2) etc. Make separate sheet for each marr.

His Father (bNC) Mother's Maiden Name (bNC)

Wife's Full Maiden Name Eva (Derosse) GREEN

	Wife's Data	Day Month Year	City, Town or Place	County or Province, etc.	State or Country	Add. Info. on Wife
	Birth	Dec 1848			IL	
	Chr'nd					
	Death	1900+				
	Burial					

Compiler M.C. McNabb	Places of Residence				
Address	Occupation	hairdresser	Church Affiliation		Military Rec.

Other husbands, if any, No. (1) (2) etc. Make separate sheet for each marr.

Date **16 Jan. 1992** Her Father (bFrance) Mother's Maiden Name (bSc)

Sex	Children's Names to Full (Arrange in order of birth)	Children's Data	Day Month Year	City, Town or Place	County or Province, etc.	State or Country	Add. Info. on Children
M	1 Leonard W	Birth	c1873-4			IL	
	Full Name of Spouse	Marr.					
		Death	1900+				
		Burial					
M	2 Frank	Birth	c1875-6			IL	
	Full Name of Spouse	Marr.					
		Death	1900+				
		Burial					
M	3 —	Birth	June 1878	Champaign (2nd ward)		IL	
	Full Name of Spouse	Marr.					
		Death	stillborn				
		Burial					
	4	Birth					
	Full Name of Spouse	Marr.					
		Death					
		Burial					
	5	Birth					
	Full Name of Spouse	Marr.					
		Death					
		Burial					
	6	Birth					
	Full Name of Spouse	Marr.					
		Death					
		Burial					
	7	Birth					
	Full Name of Spouse	Marr.					
		Death					
		Burial					
	8	Birth					
	Full Name of Spouse	Marr.					
		Death					
		Burial					
	9	Birth					
	Full Name of Spouse	Marr.					
		Death					
		Burial					
	10	Birth					
	Full Name of Spouse	Marr.					
		Death					
		Burial					

* For additional children use Everton Publishers' Children Continuation Sheet, Form A11